



SBB-02

Single Block and Bleed Valve Flange EN1092-1 x Female NPT

TECVAL SBB-02 process interface valves enables you to reduce drastically space and weight in the process of installations. It reduces the possibility of leaks and the maintenance. Their distribution diagram consist of one ball valves to block the line and one needle valve to bleed in 90° outflow.



Features

- Process interface in one compact ball/needle valve assembly.
- Flange port compatible with EN1092-1.
- Instrument port 1/2"NPT Female (ASME B1.20.1.).
- Vent port 1/2"NPT Female (ASME B1.20.1.).
- Temperature range -20°C/200°C (-4°F/392°F).
- One-Piece forged body construction.
- No ejectable ball and needle stem design.

Options

- Instrument & Vent port 1/4"NPT Female. **Y**
- Plug in vent port. **T**
- O-ring seals in several materials.

Technical data

Flange	PN	Bore	Code	A	B	C	T	L
DN15	25-40	12	1420	120	80	91	16	123
DN15	64-100	12	1421	120	80	91	20	127
DN15	160	12	1422	120	80	91	20	127
DN15	250	12	1423	120	80	91	26	137
DN20	25-40	12	1430	120	80	91	18	125
DN20	64-100	12	1431	120	80	91	22	133
DN20	160	12	1432	120	80	91	24	135
DN25	25-40	12	1433	120	80	91	18	125
DN25	25-40	15	1440	120	80	91	18	128
DN25	64-100	12	1441	120	80	91	24	135
DN25	64-100	15	1442	120	80	91	24	138
DN25	160	12	1443	120	80	91	28	144
DN25	160	15	1444	120	80	91	28	147
DN25	250	12	1445	120	80	91	28	144
DN25	250	15	1446	120	80	91	28	147
DN40	25-40	12	1447	120	80	91	18	129
DN40	25-40	15	1450	120	80	91	18	132
DN40	25-40	20	1451	120	85	95	18	145

Flange	PN	Bore	Code	A	B	C	T	L
DN40	64-100	12	1452	120	80	91	26	142
DN40	64-100	15	1453	120	80	91	26	145
DN40	64-100	20	1454	120	85	95	26	158
DN40	160	12	1455	120	80	91	34	155
DN40	160	15	1456	120	80	91	34	158
DN40	160	20	1457	120	85	95	34	171
DN40	250	12	1458	120	80	91	34	155
DN40	250	15	1459	120	80	91	34	158
DN40	250	20	1460	120	85	95	34	171
DN50	25-40	12	1461	120	80	91	20	131
DN50	25-40	15	1470	120	80	91	20	134
DN50	25-40	20	1471	120	85	95	20	147
DN50	64	12	1472	120	80	91	26	142
DN50	64	15	1473	120	80	91	26	145
DN50	64	20	1474	120	85	95	26	158
DN50	100	12	1475	120	80	91	28	149
DN50	100	15	1476	120	80	91	28	152
DN50	100	20	1477	120	85	95	28	165

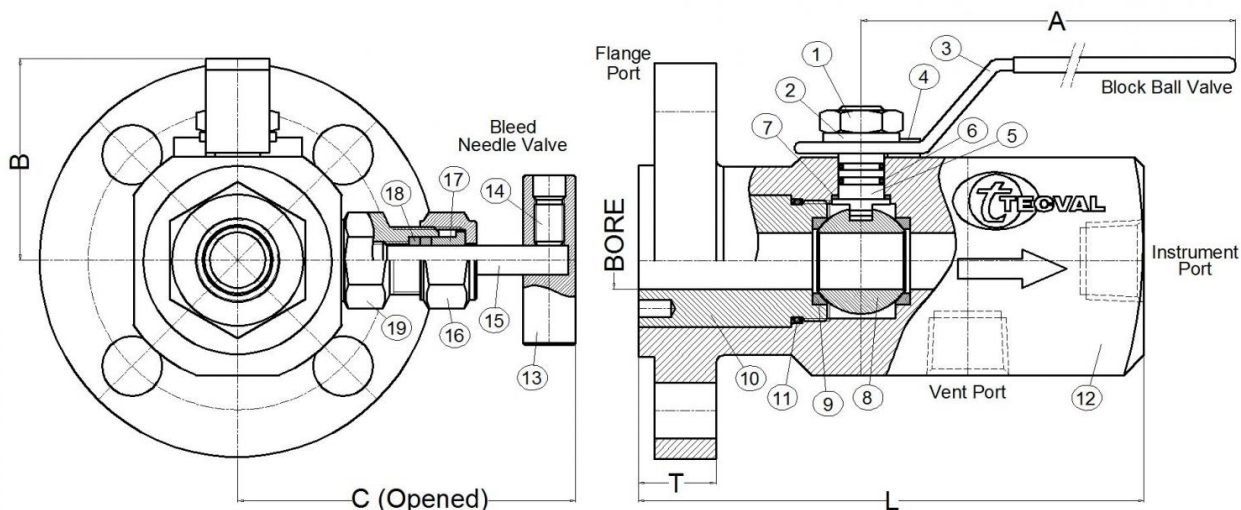

Materials

Nº Part	AISI-316L A4	SuperDuplex AS	Special Alloys
1 Handle screw	AISI-316L (1.4404)	AISI-316L (1.4404)	AISI-316L (1.4404)
2 Handle washer	AISI-316L (1.4404)	AISI-316L (1.4404)	AISI-316L (1.4404)
3 Handle	AISI-316L (1.4404)	AISI-316L (1.4404)	AISI-316L (1.4404)
4 Stop Pin	AISI-304 (1.4301)	AISI-304 (1.4301)	AISI-304 (1.4301)
5 Stem	AISI-630 (1.4542)	Superduplex (1.4410/ 1.4501)	Special alloy
6 Stem o-ring	FPM	FPM	FPM
7 Stem bearing	Delrin	Delrin	Delrin
8 Ball	AISI-630 (1.4542)	Superduplex (1.4410/ 1.4501)	Special alloy
9 Seats*	Reinforced PTFE or PEEK	Reinforced PTFE or PEEK	Reinforced PTFE or PEEK
10 Inlet Connector	AISI-316L (1.4404)	Superduplex (1.4410/ 1.4501)	Special alloy
11 Connector O-ring	FPM	FPM	FPM
12 Body	AISI-316L (1.4404)	Superduplex (1.4410/ 1.4501)	Special alloy
13 Bar handle	AISI-316L (1.4404)	AISI-316L (1.4404)	AISI-316L (1.4404)
14 Set screw	AISI-304 (1.4301)	AISI-304 (1.4301)	AISI-304 (1.4301)
15 Stem	AISI-316L (1.4404)	Superduplex (1.4410/ 1.4501)	Special alloy
16 Nut	AISI-316L (1.4404)	AISI-316L (1.4404)	AISI-316L (1.4404)
17 Gland	AISI-316L (1.4404)	AISI-316L (1.4404)	AISI-316L (1.4404)
18 Packing	P.T.F.E.	P.T.F.E.	P.T.F.E.
19 Bonnet	AISI-316L (1.4404)	Superduplex (1.4410/ 1.4501)	Special alloy

Special alloys

Manufactured in AISI-316Ti (1.4571) **A6**, AISI-904L (1.4539) **A9**, Duplex (1.4462) **AD**, 254-SMO (1.4547) **AV**, Alloy 400 (2.4360) **MO**, Alloy 625 (2.4856) **IN**, Alloy 825 (2.4858) **CO**, Titanium Gr.2 (3.7034) **TI**, Hastelloy C-276 (2.4819) **HA**.

Ordering information

References are formed by three parts:

Valve Code Look for it in the order codes chart on the previous page.

Option/s If required, add the code/s from the options section on the previous page (in alphabetical order).

Material Look for the code on the materials chart.

Example: Single Block and Bleed Valve Flange DN50 PN25 bore 15mm Superduplex with plug in vent port : **1470 T AS**

The reference required to place the order is **1470TAS**.

Maintenance

Adjustment of the needle packing may be necessary during the working life of the valve. The operation consists of turning the nut (16) clockwise. Ball Valves with long no-working period may have a harder initial operating torque.

Tests

100% tested in accordance to API STANDARD 598. Each valve is tested to check the leakage in the seats and packing. Upon request, the corresponding materials and test certificates can be delivered with the valve.

Seats*

Reinforced PTFE Seats for PN 40, PN64 and PN100.

PEEK Seats for PN160 and PN250.

Elastomers

O-ring seals (positions 6 and 11) can be made of different materials: Nitrile **B**, EPDM **E** or Neopren **N**, considering the working conditions and fluid of the valve.



TECVAL S.L.
C/Berlin, 1 Nave 4
Pol.Can Torrella
08233-VACARISSES
Barcelona - SPAIN
Tel: +34 938 280 055
tecval@tecval.es