

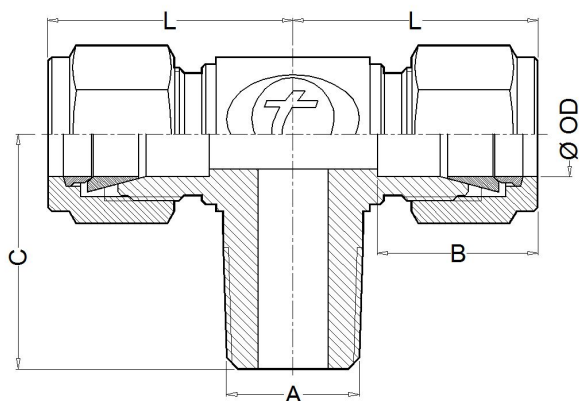

CMT

Threaded Male Tee (NPT & BSP) or Buttweld (BW) RUN DESIGN

The CMT two-ferrule compressing fittings are used to assemble a threaded or welding end to a metric or fractional tubes. RUN DESIGN. The resulting union is completely hermetic, both for high pressure and high temperatures.



Features

- Easy and fast mounting.
- Resistant to vibration.
- Hard fastening and union without twisting.
- Anti-leakage guarantee.
- Metric tube from 4mm to 25mm.
- Fractional tube from 1/8" to 1".
- Threaded NPT ends according to ANSI B1.20.1.
- Threaded BSP ends according to DIN ISO 228-1.
- Buttweld BW ends according to ANSI B16.25.

Technical data

Ø OD	A	Code NPT	Code BSP	Code BW	B (mm)	C (mm)	L (mm)
1/8"	1/8"	83600	83700	83800	13	19	25
1/8"	1/4"	83601	83701	83801	13	23	25
4	1/8"	83602	83702	83802	14	19	25
4	1/4"	83603	83703	83803	14	23	25
3/16"	1/8"	83604	83704	83804	14	19	25
3/16"	1/4"	83605	83705	83805	14	23	25
6	1/8"	83606	83706	83806	16	19	27
6	1/4"	83607	83707	83807	16	24	27
6	3/8"	83608	83708	83808	16	27	30
1/4"	1/8"	83609	83709	83809	16	19	27
1/4"	1/4"	83610	83710	83810	16	24	27
1/4"	3/8"	83611	83711	83811	16	27	30
8	1/8"	83612	83712	83812	17	20	29
8	1/4"	83613	83713	83813	17	25	29
8	3/8"	83614	83714	83814	17	27	30
3/8"	1/8"	83615	83715	83815	17	20	31
3/8"	1/4"	83616	83716	83816	17	25	31
3/8"	3/8"	83617	83717	83817	17	27	31
3/8"	1/2"	83618	83718	83818	17	32	31
10	1/8"	83619	83719	83819	17	21	31
10	1/4"	83620	83720	83820	17	26	31

Ø OD	A	Code NPT	Code BSP	Code BW	B (mm)	C (mm)	L (mm)
10	3/8"	83621	83721	83821	17	27	31
10	1/2"	83622	83722	83822	17	32	32
12	1/4"	83623	83723	83823	23	28	36
12	3/8"	83624	83724	83824	23	29	36
12	1/2"	83625	83725	83825	23	33	36
1/2"	1/4"	83626	83726	83826	23	28	36
1/2"	3/8"	83627	83727	83827	23	29	36
1/2"	1/2"	83628	83728	83828	23	33	36
5/8"	1/4"	83629	83729	83829	24	33	40
5/8"	3/8"	89530	89630	83830	24	33	40
5/8"	1/2"	83631	83731	83831	24	37	40
16	1/4"	83632	83732	83832	24	33	40
16	3/8"	83633	83733	83833	24	33	40
16	1/2"	83634	83734	83834	24	37	40
18	3/8"	83635	83735	83835	24	33	40
18	1/2"	83636	83736	83836	24	37	40
18	3/4"	83637	83737	83837	24	38	40
3/4"	3/8"	83638	83738	83838	24	33	40
3/4"	1/2"	83639	83739	83839	24	37	40
3/4"	3/4"	83640	83740	83840	24	38	40
3/4"	1"	83641	83741	83841	24	47	44

Technical data

Ø OD	A	Code NPT	Code BSP	Code BW	B (mm)	C (mm)	L (mm)	Ø OD	A	Code NPT	Code BSP	Code BW	B (mm)	C (mm)	L (mm)
20	3/8"	83642	83742	83842	26	33	40	7/8"	1/2"	83648	83748	83848	26	37	40
20	1/2"	83643	83743	83843	26	37	40	7/8"	3/4"	83649	83749	83849	26	38	40
20	3/4"	83644	83744	83844	26	38	40	25	3/4"	83650	83750	83850	31	42	49
20	1"	83645	83745	83845	26	47	44	25	1"	83651	83751	83851	31	47	49
22	1/2"	83646	83746	83846	26	37	40	1"	3/4"	83652	83752	83852	31	42	49
22	3/4"	83647	83747	83847	26	38	40	1"	1"	83653	83753	83853	31	47	49

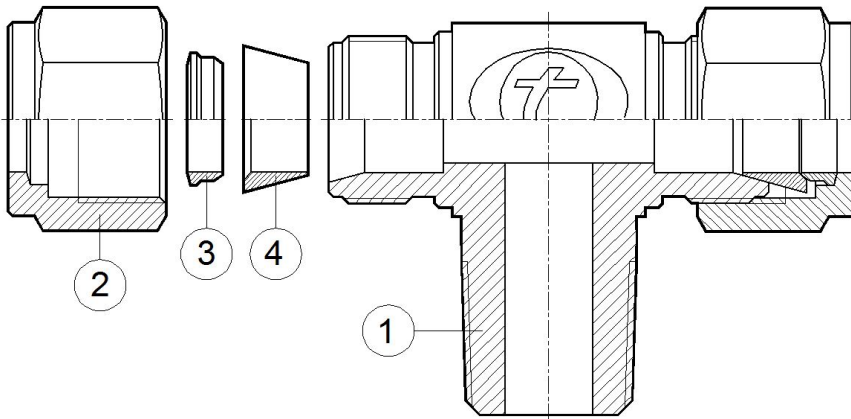

Packaging

All TECVAL fittings are supplied packed in individual polyethylene airtight bags. Everything is 100% recyclable.

Assembly process

Insert the tube to the bottom of the end connector, and tight the nut manually. Then, fasten the body of the connector with a spanner, and with another spanner tight the nut 1 turn and 1/4 (1). For tube of 1/8 and 4mm just tight 3/4 turn (2). The result is a hard fastening, no leakage union without twisting and safe from the connector to the tube.

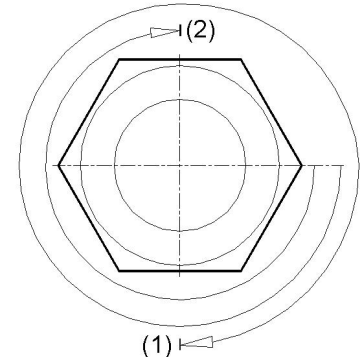

Materials

Nº Part	AISI-316L A4	Duplex AD	SuperDuplex AS	Special alloys
1 Body	AISI-316L (1.4404)	Duplex (1.4462)	Superduplex (1.4410/1.4501)	Special alloy
2 Nut	AISI-316L (1.4404)	Duplex (1.4462)	Superduplex (1.4410/1.4501)	Special alloy
3 Back ferrule	AISI-316L (1.4404)	Duplex (1.4462)	Superduplex (1.4410/1.4501)	Special alloy
4 Front ferrule	AISI-316L (1.4404)	Duplex (1.4462)	Superduplex (1.4410/1.4501)	Special alloy

Special alloys

Among the wide range of alloys existing, TECVAL has selected those considered by our customers as most suitable, which we stock to ensure a quick and effective supply: AISI-316Ti (1.4571) **A6**, AISI-904L (1.4539) **A9**, Alloy 400 (2.4360) **MO**, Alloy 625 (2.4856) **IN**, Alloy 825 (2.4858) **CO**, 254-SMO (1.4547) **AV**, Titanium Gr.2 (3.7034) **TI**, Hastelloy C-276 (2.4819) **HA**. Whether you do not find the required alloy or need further information about our special alloys valves and fittings, please address your inquiry to our Technical Department.

Ordering information

The fittings references are formed in two parts:

Fitting Code Look for it in the technical data.

Material Code Look for it in the materials list.

Example: Threaded Male Tee RUN DESING CMT 1/4"OD x 1/8"NPT AISI-904L will be: **83609 A9**.

The reference required to place the order is **83609A9**.



TECVAL S.L.
C/Berlin, 1 Nave 4
Pol.Can Torrella
08233-VACARISSES
Barcelona - SPAIN
Tel: +34 938 280 055
tecval@tecval.es