

CME

Adapter Tube Connection to (NPT, BSP, SW o BW)

The CME Adapter is used to connect easily two pipes or components with two-ferrule compression connection in one site and threaded or welding connection in the other site

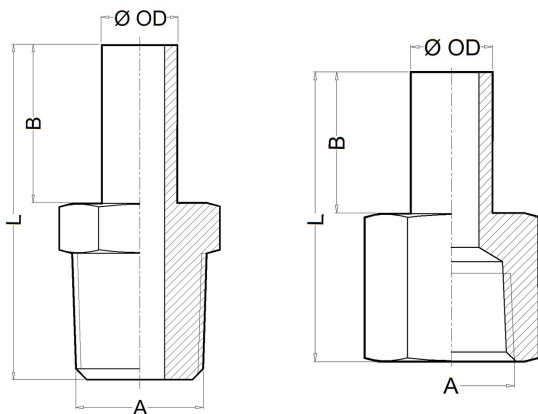

Features

- Easy and fast mounting.
- Resistant to vibration.
- Hard fastening and union without twisting.
- Anti-leakage guarantee.
- Metric tube from 4mm to 25mm.
- Fractional tube from 1/8" to 1".
- Threaded NPT ends according to ANSI B1.20.1.
- Threaded BSP ends according to DIN ISO 228-1.
- Buttweld BW ends according to ANSI B16.25.
- Socket Weld SW ends according to ANSI B16.25.

Technical data

A	OD	Code NPT	Code BSP	Code BW	Code SW	L (mm)	B (mm)
1/8"M	1/8"	87000	87100	87200	-	28	13
1/8"H	1/8"	87300	87400	-	87500	27	13
1/4"M	1/8"	87001	87101	87201	-	33	13
1/4"H	1/8"	87301	87401	-	87501	32	13
1/8"M	4	87002	87102	87202	-	29	14
1/8"H	4	87302	87402	-	87502	28	14
1/4"M	4	87003	87103	87203	-	34	14
1/4"H	4	87303	87403	-	87503	33	14
1/8"M	3/16"	87004	87104	87204	-	29	14
1/8"H	3/16"	87304	87404	-	87504	28	14
1/4"M	3/16"	87005	87105	87205	-	34	14
1/4"H	3/16"	87305	87405	-	87505	33	14
1/8"M	6	87006	87106	87206	-	31	16
1/8"H	6	87306	87406	-	87506	29	16
1/4"M	6	87007	87107	87207	-	36	16
1/4"H	6	87307	87407	-	87507	35	16
3/8"M	6	87008	87108	87208	-	37	16
3/8"H	6	87308	87408	-	87508	36	16
1/2"M	6	87009	87109	87209	-	41	16
1/2"H	6	87309	87409	-	87509	41	16
1/8"M	1/4"	87010	87110	87210	-	31	16

A	OD	Code NPT	Code BSP	Code BW	Code SW	L (mm)	B (mm)
1/8"H	1/4"	87310	87410	-	87510	29	16
1/4"M	1/4"	87011	87111	87211	-	36	16
1/4"H	1/4"	87311	87411	-	87511	35	16
3/8"M	1/4"	87012	87112	87212	-	37	16
3/8"H	1/4"	87312	87412	-	87512	36	16
1/2"M	1/4"	87013	87113	87213	-	41	16
1/2"H	1/4"	87313	87413	-	87513	41	16
1/8"M	8	87014	87114	87214	-	31	17
1/8"H	8	87314	87414	-	87514	30	17
1/4"M	8	87015	87115	87215	-	36	17
1/4"H	8	87315	87415	-	87515	35	17
3/8"M	8	87016	87116	87216	-	38	17
3/8"H	8	87316	87416	-	87516	36	17
1/2"M	8	87017	87117	87217	-	42	17
1/2"H	8	87317	87417	-	87517	41	17
1/8"M	3/8"	87018	87118	87218	-	32	17
1/8"H	3/8"	87318	87418	-	87518	30	17
1/4"M	3/8"	87019	87119	87219	-	37	17
1/4"H	3/8"	87319	87419	-	87519	35	17
3/8"M	3/8"	87020	87120	87220	-	38	17
3/8"H	3/8"	87320	87420	-	87520	37	17

Technical data

A	OD	Code NPT	Code BSP	Code BW	Code SW	L (mm)	B (mm)	A	OD	Code NPT	Code BSP	Code BW	Code SW	L (mm)	B (mm)
1/2"M	3/8"	87021	87121	87221	-	43	17	1/2"M	16	87036	87136	87236	-	50	24
1/2"H	3/8"	87321	87421	-	87521	42	17	1/2"H	16	87336	87436	-	87536	49	24
1/8"M	10	87022	87122	87222	-	32	17	3/4"M	16	87037	87137	87237	-	53	24
1/8"H	10	87322	87422	-	87522	30	17	3/4"H	16	87337	87437	-	87537	51	24
1/4"M	10	87023	87123	87223	-	37	17	3/8"M	18	87038	87138	87238	-	46	24
1/4"H	10	87323	87423	-	87523	35	17	3/8"H	18	87338	87438	-	87538	43	24
3/8"M	10	87024	87124	87224	-	39	17	1/2"M	18	87039	87139	87239	-	50	24
3/8"H	10	87324	87424	-	87524	37	17	1/2"H	18	87339	87439	-	87539	49	24
1/2"M	10	87025	87125	87225	-	43	17	3/4"M	18	87040	87140	87240	-	53	24
1/2"H	10	87325	87425	-	87525	42	17	3/4"H	18	87340	87440	-	87540	51	24
1/4"M	12	87026	87126	87226	-	43	23	1/2"M	3/4"	87041	87141	87241	-	50	24
1/4"H	12	87326	87426	-	87526	41	23	1/2"H	3/4"	87341	87441	-	87541	49	24
3/8"M	12	87027	87127	87227	-	44	23	3/4"M	3/4"	87042	87142	87242	-	53	24
3/8"H	12	87327	87427	-	87527	42	23	3/4"H	3/4"	87342	87442	-	87542	51	24
1/2"M	12	87028	87128	87228	-	48	23	1"M	3/4"	87043	87143	87243	-	59	24
1/2"H	12	87328	87428	-	87528	48	23	1"H	3/4"	87343	87443	-	87543	56	24
1/4"M	1/2"	87029	87129	87229	-	43	23	1/2"M	20	87044	87144	87244	-	51	25
1/4"H	1/2"	87329	87429	-	87529	41	23	1/2"H	20	87344	87444	-	87544	49	25
3/8"M	1/2"	87030	87130	87230	-	44	23	3/4"M	20	87045	87145	87245	-	54	25
3/8"H	1/2"	87330	87430	-	87530	42	23	3/4"H	20	87345	87445	-	87545	51	25
1/2"M	1/2"	87031	87131	87231	-	48	23	1"M	20	87046	87146	87246	-	60	25
1/2"H	1/2"	87331	87431	-	87531	48	23	1"H	20	87346	87446	-	87546	57	25
3/8"M	5/8"	87032	87132	87232	-	46	24	3/4"M	22	87047	87147	87247	-	54	26
3/8"H	5/8"	87332	87432	-	87532	43	24	3/4"H	22	87347	87447	-	87547	52	26
1/2"M	5/8"	87033	87133	87233	-	50	24	3/4"M	7/8"	87048	87148	87248	-	54	26
1/2"H	5/8"	87333	87433	-	87533	49	24	3/4"H	7/8"	87348	87448	-	87548	52	26
3/4"M	5/8"	87034	87134	87234	-	53	24	3/4"M	25	87049	87149	87249	-	60	31
3/4"H	5/8"	87334	87434	-	87534	51	24	3/4"H	25	87349	87449	-	87549	57	31
3/8"M	16	87035	87135	87235	-	46	24	3/4"M	1"	87050	87150	87250	-	60	31
3/8"H	16	87335	87435	-	87535	43	24	3/4"H	1"	87350	87450	-	87550	57	31

Materials

Nº Part	AISI-316L A4	Duplex AD	SuperDuplex AS	Special Alloys
1 CME	AISI-316L (1.4404)	Duplex (1.4462)	SuperDuplex (1.4410 / 1.4501)	Special alloy

Materials

AISI-316L (1.4404) **A4**, AISI-316Ti (1.4571) **A6**, AISI-904L (1.4539) **A9**, Duplex (1.4462) **AD**, SuperDuplex (1.4410 / 1.4501) **AS**, 254-SMO (1.4547) **AV**, Titanium Gr.2 (1.7864) **TI**, Hastelloy C-276 (2.4819) **HA**. Whether you do not find the required alloy or need further information about our special alloys valves and fittings, please address your inquiry to our Technical Department.

Ordering information

The fittings references are formed in two parts:

Fitting Code Look for it in the technical data.

Material Code Look for it in the materials list.

Example: Tube Adapter Connection CME 1/2"OD x 1/4" (M) BW AISI-316L will be: **87229 A4**.

The reference required to place the order is **87229A4**.

Packaging

All TECVAL fittings are supplied packed in individual polyethylene airtight bags. Everything is 100% recyclable.



TECVAL S.L.
C/Berlin, 1 Nave 4
Pol.Can Torrella
08233-VACARISSES
Barcelona - SPAIN
Tel: +34 938 280 055
tecval@tecval.es