

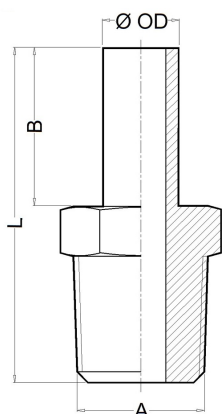

# CME

## Male Tube Connection (NPT & BSP-T)

The CME Adapter is used to connect easily two pipes or components with two-ferrule compression connection in one site and threaded connection in the other site



### Features

- Easy and fast mounting.
- Resistant to vibration.
- Hard fastening and union without twisting.
- Anti-leakage guarantee.
- Metric tube from 6mm to 12mm.
- Fractional tube from 1/4" to 3/4".
- Threaded NPT ends according to ANSI B1.20.1.
- Threaded BSP-T ends according to ISO 7/1 & EN 10226-1.

### Technical data

A	OD	Code NPT	Code BSP-T	L (mm)	B (mm)
1/4"	6	87007	87107	36	16
1/4"	1/4"	87011	87111	36	16
1/4"	8	87015	87115	36	17
1/4"	3/8"	87019	87119	37	17
1/2"	3/8"	87021	87121	43	17
1/4"	10	87023	87123	37	17

A	OD	Code NPT	Code BSP-T	L (mm)	B (mm)
1/2"	10	87025	87125	43	17
1/2"	12	87028	87128	48	23
1/4"	1/2"	87029	87129	43	23
1/2"	1/2"	87031	87131	48	23
1/2"	3/4"	87041	87141	50	24
3/4"	3/4"	87042	87142	53	24

### Materials

SuperDuplex (1.4410 / 1.4501) **AS**

AISI-904L (1.4539) **A9**

### Ordering information

The fittings references are formed in two parts:

**Fitting Code** Look for it in the technical data.

**Material Code** Look for it in the materials list.

Example: Threaded Male Connector CMR 1/4"OD x 1/4"NPT Superduplex will be: **80012 AS**.

The reference required to place the order is **80012AS**.

### Packaging

All TECVAL fittings are supplied packed in individual polyethylene airtight bags. Everything is 100% recyclable.



TECVAL S.L.  
C/Berlin, 1 Nave 4  
Pol.Can Torrella  
08233-VACARISSES  
Barcelona - SPAIN  
Tel: +34 938 280 055  
tecval@tecval.es