

CMC

Threaded Male Elbow (NPT & BSP) or Buttweld (BW)

The CMC two-ferrule compressing fittings are used to assemble on 90° a threaded or welding end to a metric or fractional tube. The resulting union is completely hermetic, both for high pressure and high temperatures.

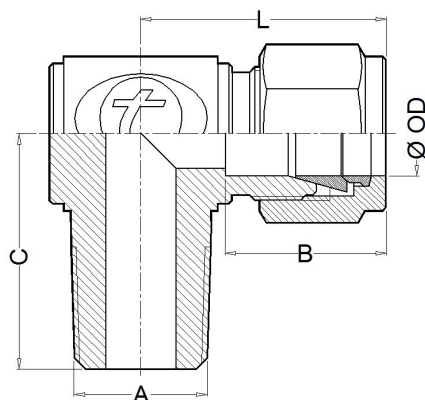

Features

- Easy and fast mounting.
- Resistant to vibration.
- Hard fastening and union without twisting.
- Anti-leakage guarantee.
- Metric tube from 4mm to 25mm.
- Fractional tube from 1/8" to 1".
- Threaded NPT ends according to ANSI B1.20.1.
- Threaded BSP ends according to DIN ISO 228-1.
- Buttweld BW ends according to ANSI B16.25.

Technical data

Ø OD	A	Code NPT	Code BSP	Code BW	B (mm)	C (mm)	L (mm)	Ø OD	A	Code NPT	Code BSP	Code BW	B (mm)	C (mm)	L (mm)
1/8"	1/8"	82400	82500	82600	13	19	25	10	3/8"	82421	82521	82621	17	27	31
1/8"	1/4"	82401	82501	82601	13	23	25	10	1/2"	82422	82522	82622	17	32	32
4	1/8"	82402	82502	82602	14	19	25	12	1/4"	82423	82523	82623	23	28	36
4	1/4"	82403	82503	82603	14	23	25	12	3/8"	82424	82524	82624	23	29	36
3/16"	1/8"	82404	82504	82604	14	19	25	12	1/2"	82425	82525	82625	23	33	36
3/16"	1/4"	82405	82505	82605	14	23	25	1/2"	1/4"	82426	82526	82626	23	28	36
6	1/8"	82406	82506	82606	16	19	27	1/2"	3/8"	82427	82527	82627	23	29	36
6	1/4"	82407	82507	82607	16	24	27	1/2"	1/2"	82428	82528	82628	23	33	36
6	3/8"	82408	82508	82608	16	27	30	5/8"	1/4"	82429	82529	82629	24	33	40
1/4"	1/8"	82409	82509	82609	16	19	27	5/8"	3/8"	88330	88430	88530	24	33	40
1/4"	1/4"	82410	82510	82610	16	24	27	5/8"	1/2"	82431	82531	82631	24	37	40
1/4"	3/8"	82411	82511	82611	16	27	30	16	1/4"	82432	82532	82632	24	33	40
8	1/8"	82412	82512	82612	17	20	29	16	3/8"	82433	82533	82633	24	33	40
8	1/4"	82413	82513	82613	17	25	29	16	1/2"	82434	82534	82634	24	37	40
8	3/8"	82414	82514	82614	17	27	30	18	3/8"	82435	82535	82635	24	33	40
3/8"	1/8"	82415	82515	82615	17	20	31	18	1/2"	82436	82536	82636	24	37	40
3/8"	1/4"	82416	82516	82616	17	25	31	18	3/4"	82437	82537	82637	24	38	40
3/8"	3/8"	82417	82517	82617	17	27	31	3/4"	3/8"	82438	82538	82638	24	33	40
3/8"	1/2"	82418	82518	82618	17	32	31	3/4"	1/2"	82439	82539	82639	24	37	40
10	1/8"	82419	82519	82619	17	21	31	3/4"	3/4"	82440	82540	82640	24	38	40
10	1/4"	82420	82520	82620	17	26	31	3/4"	1"	82441	82541	82641	24	47	44

Technical data

Ø OD	A	Code NPT	Code BSP	Code BW	B (mm)	C (mm)	L (mm)	Ø OD	A	Code NPT	Code BSP	Code BW	B (mm)	C (mm)	L (mm)
20	3/8"	82442	82542	82642	26	33	40	7/8"	1/2"	82448	82548	82648	26	37	40
20	1/2"	82443	82543	82643	26	37	40	7/8"	3/4"	82449	82549	82649	26	38	40
20	3/4"	82444	82544	82644	26	38	40	25	3/4"	82450	82550	82650	31	42	49
20	1"	82445	82545	82645	26	47	44	25	1"	82451	82551	82651	31	47	49
22	1/2"	82446	82546	82646	26	37	40	1"	3/4"	82452	82552	82652	31	42	49
22	3/4"	82447	82547	82647	26	38	40	1"	1"	82453	82553	82653	31	47	49

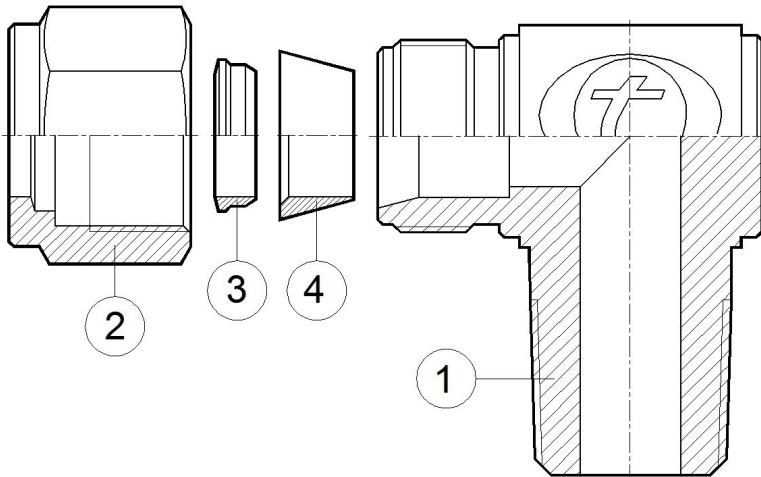

Packaging

All TECVAL fittings are supplied packed in individual polyethylene airtight bags. Everything is 100% recyclable.

Assembly process

Insert the tube to the bottom of the end connector, and tight the nut manually. Then, fasten the body of the connector with a spanner, and with another spanner tight the nut 1 turn and 1/4 (1). For tube of 1/8 and 4mm just tight 3/4 turn (2). The result is a hard fastening, no leakage union without twisting and safe from the connector to the tube.

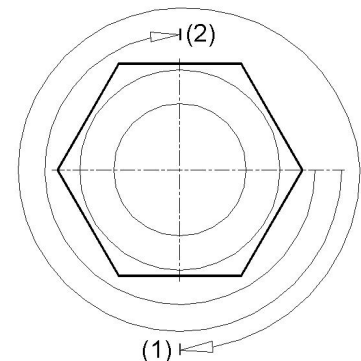

Materials

Nº Part	AISI-316L A4	Duplex AD	SuperDuplex AS	Special alloys
1 Body	AISI-316L (1.4404)	Duplex (1.4462)	Superduplex (1.4410/1.4501)	Special alloy
2 Nut	AISI-316L (1.4404)	Duplex (1.4462)	Superduplex (1.4410/1.4501)	Special alloy
3 Back ferrule	AISI-316L (1.4404)	Duplex (1.4462)	Superduplex (1.4410/1.4501)	Special alloy
4 Front ferrule	AISI-316L (1.4404)	Duplex (1.4462)	Superduplex (1.4410/1.4501)	Special alloy

Special alloys

Special alloys Among the wide range of alloys existing, TECVAL has selected those considered by our customers as most suitable, which we stock to ensure a quick and effective supply: AISI-316Ti (1.4571) **A6**, AISI-904L (1.4539) **A9**, Alloy 400 (2.4360) **MO**, Alloy 625 (2.4856) **IN**, Alloy 825 (2.4858) **CO**, 254-SMO (1.4547) **AV**, Titanium Gr.2 (3.7034) **TI**, Hastelloy C-276 (2.4819) **HA**. Whether you do not find the required alloy or need further information about our special alloys valves and fittings, please address your inquiry to our Technical Department.

Ordering information

The fittings references are formed in two parts:

Fitting Code Look for it in the technical data.

Material Code Look for it in the materials list.

Example: Threaded Male Elbow CMC 8mm OD x 1/8" BSP Duplex will be:

82512 AD. The reference required to place the order is **82512AD**.



TECVAL S.L.
C/Berlin, 1 Nave 4
Pol.Can Torrella
08233-VACARISSES
Barcelona - SPAIN
Tel: +34 938 280 055
tecval@tecval.es