

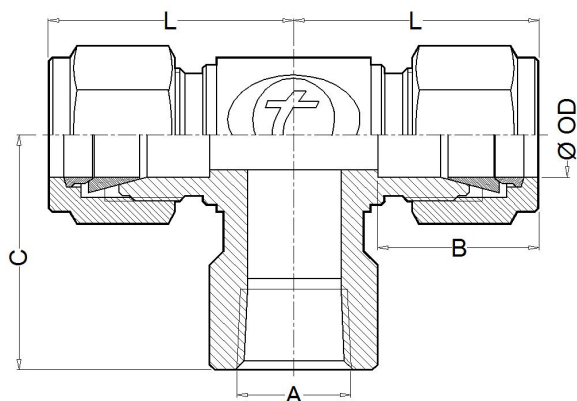

CHT

Threated Female Tee (NPT & BSP) or Socket Weld (SW) RUN DESIGN

The CHT two-ferrule compressing fittings are used to assemble a threaded or welding end to a metric or fractional tubes. RUN DESIGN. The resulting union is completely hermetic, both for high pressure and high temperatures.



Features

- Easy and fast mounting.
- Resistant to vibration.
- Hard fastening and union without twisting.
- Anti-leakage guarantee.
- Metric tube from 4mm to 25mm.
- Fractional tube from 1/8" to 1".
- Threaded NPT ends according to ANSI B1.20.1.
- Threaded BSP ends according to DIN ISO 228-1.
- Socket Weld SW ends according to ANSI B16.11.

Technical data

Ø OD	A	Code NPT	Code BSP	Code SW	B (mm)	C (mm)	L (mm)
1/8"	1/8"	84400	84500	84600	13	19	25
1/8"	1/4"	84401	84501	84601	13	23	25
4	1/8"	84402	84502	84602	14	19	25
4	1/4"	84403	84503	84603	14	23	25
3/16"	1/8"	84404	84504	84604	14	19	25
3/16"	1/4"	84405	84505	84605	14	23	25
6	1/8"	84406	84506	84606	16	19	27
6	1/4"	84407	84507	84607	16	24	27
6	3/8"	84408	84508	84608	16	27	30
1/4"	1/8"	84409	84509	84609	16	19	27
1/4"	1/4"	84410	84510	84610	16	24	27
1/4"	3/8"	84411	84511	84611	16	27	30
8	1/8"	84412	84512	84612	17	20	29
8	1/4"	84413	84513	84613	17	25	29
8	3/8"	84414	84514	84614	17	27	30
3/8"	1/8"	84415	84515	84615	17	20	31
3/8"	1/4"	84416	84516	84616	17	25	31
3/8"	3/8"	84417	84517	84617	17	27	31
3/8"	1/2"	84418	84518	84618	17	32	31
10	1/8"	84419	84519	84619	17	21	31
10	1/4"	84420	84520	84620	17	26	31

Ø OD	A	Code NPT	Code BSP	Code SW	B (mm)	C (mm)	L (mm)
10	3/8"	84421	84521	84621	17	27	31
10	1/2"	84422	84522	84622	17	32	32
12	1/4"	84423	84523	84623	23	28	36
12	3/8"	84424	84524	84624	23	29	36
12	1/2"	84425	84525	84625	23	33	36
1/2"	1/4"	84426	84526	84626	23	28	36
1/2"	3/8"	84427	84527	84627	23	29	36
1/2"	1/2"	84428	84528	84628	23	33	36
5/8"	1/4"	84429	84529	84629	24	33	40
5/8"	3/8"	84430	84530	84630	24	33	40
5/8"	1/2"	84431	84531	84631	24	37	40
16	1/4"	84432	84532	84632	24	33	40
16	3/8"	84433	84533	84633	24	33	40
16	1/2"	84434	84534	84634	24	37	40
18	3/8"	84435	84535	84635	24	33	40
18	1/2"	84436	84536	84636	24	37	40
18	3/4"	84437	84537	84637	24	38	40
3/4"	3/8"	84438	84538	84638	24	33	40
3/4"	1/2"	84439	84539	84639	24	37	40
3/4"	3/4"	84440	84540	84640	24	38	40
3/4"	1"	84441	84541	84641	24	47	44

Technical data

Ø OD	A	Code NPT	Code BSP	Code SW	B (mm)	C (mm)	L (mm)
20	3/8"	84442	84542	84642	26	33	40
20	1/2"	84443	84543	84643	26	37	40
20	3/4"	84444	84544	84644	26	38	40
20	1"	84445	84545	84645	26	47	44
22	1/2"	84446	84546	84646	26	37	40
22	3/4"	84447	84547	84647	26	38	40

Ø OD	A	Code NPT	Code BSP	Code SW	B (mm)	C (mm)	L (mm)
7/8"	1/2"	84448	84548	84648	26	37	40
7/8"	3/4"	84449	84549	84649	26	38	40
25	3/4"	84450	84550	84650	31	42	49
25	1"	84451	84551	84651	31	47	49
1"	3/4"	84452	84552	84652	31	42	49
1"	1"	84453	84553	84653	31	47	49

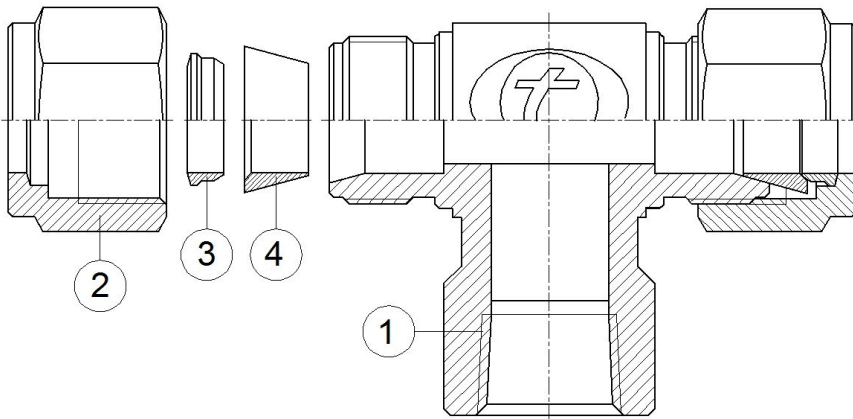

Packaging

All TECVAL fittings are supplied packed in individual polyethylene airtight bags. Everything is 100% recyclable.

Assembly process

Insert the tube to the bottom of the end connector, and tight the nut manually. Then, fasten the body of the connector with a spanner, and with another spanner tight the nut 1 turn and 1/4 (1). For tube of 1/8 and 4mm just tight 3/4 turn (2). The result is a hard fastening, no leakage union without twisting and safe from the connector to the tube.

Materials

Nº Part	AISI-316L A4	Duplex AD	SuperDuplex AS	Special alloys
1 Body	AISI-316L (DIN 1.4404)	Duplex (1.4462)	Superduplex (1.4410/1.4501)	Special alloy
2 Nut	AISI-316L (DIN 1.4404)	Duplex (1.4462)	Superduplex (1.4410/1.4501)	Special alloy
3 Back ferrule	AISI-316L (DIN 1.4404)	Duplex (1.4462)	Superduplex (1.4410/1.4501)	Special alloy
4 Front ferrule	AISI-316L (DIN 1.4404)	Duplex (1.4462)	Superduplex (1.4410/1.4501)	Special alloy

Special alloys

Among the wide range of alloys existing, TECVAL has selected those considered by our customers as most suitable, which we stock to ensure a quick and effective supply: AISI-316Ti (1.4571) **A6**, AISI-904L (1.4539) **A9**, Alloy 400 (2.4360) **MO**, Alloy 625 (2.4856) **IN**, Alloy 825 (2.4858) **CO**, 254-SMO (1.4547) **AV**, Titanium Gr.2 (3.7034) **TI**, Hastelloy C-276 (2.4819) **HA**. Whether you do not find the required alloy or need further information about our special alloys valves and fittings, please address your inquiry to our Technical Department.

Ordering information

The fittings references are formed in two parts:

Fitting Code Look for it in the technical data.

Material Code Look for it in the materials list.

Example: Threaded Female Tee RUN DESING CHT 3/8"OD x 1/2"SW SuperDuplex will be: **84618 AS**.

The reference required to place the order is **84618AS**.

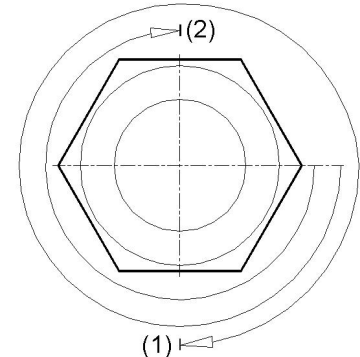

TECVAL S.L.
C/Berlin, 1 Nave 4
Pol.Can Torrella
08233-VACARISSES
Barcelona - SPAIN
Tel: +34 938 280 055
tecval@tecval.es